

Single N-Channel MOSFET

DESCRIPTION

SMC4862NA is the N-Channel enhancement mode power field effect transistors are using trench DMOS technology. This advanced technology has been especially tailored to minimize on-state resistance, provide superior, fast switching performance. These devices are well suited for high efficiency fast switching applications.

PART NUMBER INFORMATION

SMC 4862 NA - TR G
 a b c d e

- a : Company name.
- b : Product Serial number.
- c : Package code NA:DFN3.3X3.3A-8
- d : Handling code TR:Tape&Reel
- e : Green produce code G:RoHS Compliant

FEATURES

$V_{DS}=30V, I_D=50A$

$R_{DS(ON)}=4.5m\Omega(Typ.)@V_{GS}=10V$

$R_{DS(ON)}=5.5m\Omega(Typ.)@V_{GS}=4.5V$

- ◆ 100% UIS and Rg tested
- ◆ High power and current handling capability

APPLICATIONS

- ◆ Power Management
- ◆ DC/DC Converters
- ◆ Load Switch



ABSOLUTE MAXIMUM RATINGS ($T_A = 25^\circ C$ Unless otherwise noted)

Symbol	Parameter	Rating	Units
V_{DSS}	Drain-Source Voltage	30	V
V_{GSS}	Gate-Source Voltage	± 20	V
I_D	Pulsed Drain Current ^A	$T_C=25^\circ C$	50
		$T_C=100^\circ C$	36.5
I_{DM}	Pulsed Drain Current ^B	150	A
I_D	Continuous Drain Current	$T_A=25^\circ C$	20
		$T_A=70^\circ C$	16
P_D	Power Dissipation ^A	$T_A=25^\circ C$	3.6
		$T_A=70^\circ C$	2.3
I_{AS}	Avalanche Current ^B	30	A
E_{AS}	Single Pulse Avalanche energy $L=0.1mH$ ^B	45	mJ
P_D	Power Dissipation ^C	$T_C=25^\circ C$	29.8
		$T_C=100^\circ C$	11.9
T_J	Operation Junction Temperature	-55/150	$^\circ C$
T_{STG}	Storage Temperature Range	-55/150	$^\circ C$

THERMAL RESISTANCE

Symbol	Parameter	Typ	Max	Units
$R_{\theta JA}$	Thermal Resistance Junction to Ambient ^A		35	$^\circ C/W$
	Thermal Resistance Junction to Ambient ^{AC}	$t \leq 10s$	65	
$R_{\theta JC}$	Thermal Resistance Junction to Case	Steady-State	4.2	

ELECTRICAL CHARACTERISTICS ($T_A = 25^\circ\text{C}$ Unless otherwise noted)

Symbol	Parameter	Condition	Min	Typ	Max	Unit
Static Parameters						
BV _{DSS}	Drain-Source Breakdown Voltage	V _{GS} =0V, I _D =250 μ A	30			V
V _{GS(th)}	Gate Threshold Voltage	V _{DS} =V _{GS} , I _D =250 μ A	1	1.6	2.5	V
I _{GSS}	Gate Leakage Current	V _{DS} =0V, V _{GS} = \pm 20V			\pm 100	nA
I _{DSS}	Zero Gate Voltage Drain Current	V _{DS} =30V, V _{GS} =0V, T _J =25 $^\circ$ C			1	μ A
		V _{DS} =24V, V _{GS} =0V, T _J =75 $^\circ$ C			10	
R _{DS(ON)}	Drain-source On-Resistance ^D	V _{GS} =10V, I _D =20A V _{GS} =4.5V, I _D =12A		4.5 5.5	6 7	m Ω
G _{fs}	Forward Transconductance	V _{DS} =10V, I _D =10A		62		S
Diode Characteristics						
V _{SD}	Diode Forward Voltage ^D	I _S =1A, V _{GS} =0V			1	V
I _S	Diode Continuous Forward Current				29	A
t _{rr}	Reverse Recovery Time	I _S =10A, dI/dt=100A/ μ s		25		ns
Q _{rr}	Reverse Recovery Charge			12		nC
Dynamic and Switching Parameters^E						
Q _g	Total Gate Charge	V _{DS} =15V, V _{GS} =10V, I _D =10A		19.7	27.6	nC
Q _g	Total Gate Charge (4.5V)			9.6	12	
Q _{gs}	Gate-Source Charge			5	6.3	
Q _{gd}	Gate-Drain Charge			3.8	5.1	
C _{iss}	Input Capacitance	V _{DS} =15V, V _{GS} =0V, f=1MHz		1750		pF
C _{oss}	Output Capacitance			267		
C _{rss}	Reverse Transfer Capacitance			168		
R _g	Gate Resistance	V _{GS} =0V, V _{DS} =0V, F=1MHz		2.2		Ω
t _{d(on)}	Turn-On Time	V _{DD} =15V, V _{GEN} =10V R _G =6 Ω , I _D =1A		9	17	nS
t _r				6	12	
t _{d(off)}	Turn-Off Time			32.4	62	
t _f				9.2	17	

Note: Absolute maximum ratings are those values beyond which the device could be permanently damaged.

- A. Surface mounted on FR4 board using 1 in² pad size.
- B. Pulsed width limited by maximum junction temperature, T_{J(MAX)}=150 $^\circ$ C.
- C. Using \leq 10s junction-to-ambient thermal resistance is base on T_{J(MAX)}=150 $^\circ$ C.
- D. Pulse test width \leq 300 μ s and duty cycle \leq 2%.
- E. Guaranteed by design, not subject to production testing.
- *. Maximum rated current is limited by the package.

The products and product specifications contained herein are subject to change without notice to improve performance characteristics. Consult us, or our representatives before use, to confirm that the information in this datasheet is up to date. We assume no responsibility for any infringement of patents, patent rights, or other rights arising from the use of any information and circuitry in this datasheet.

TYPICAL CHARACTERISTICS

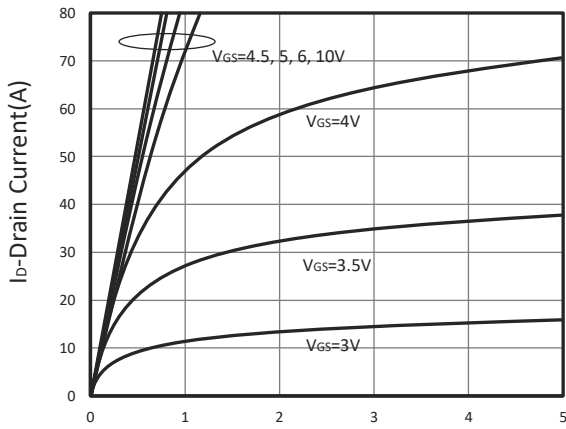

V_{DS}-Drain Source Voltage (V)
Output Characteristics

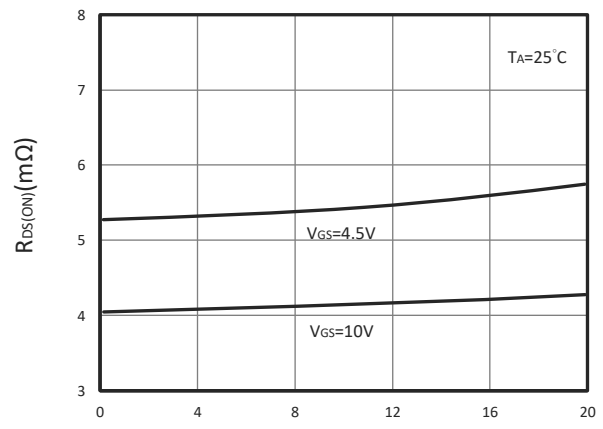

Id-Drain Current (A)
Drain-Source On Resistance

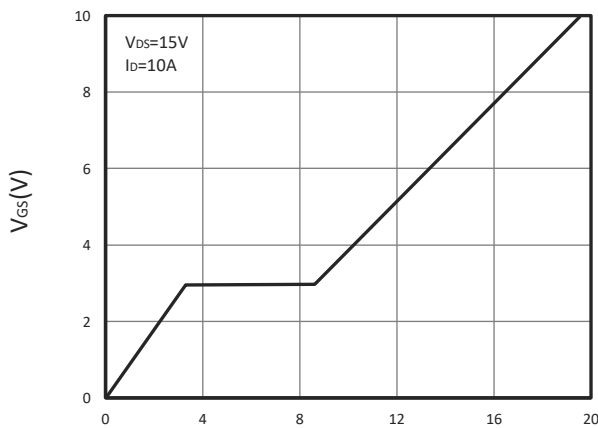

Qg-Gate Charge (nC)
Gate Charge

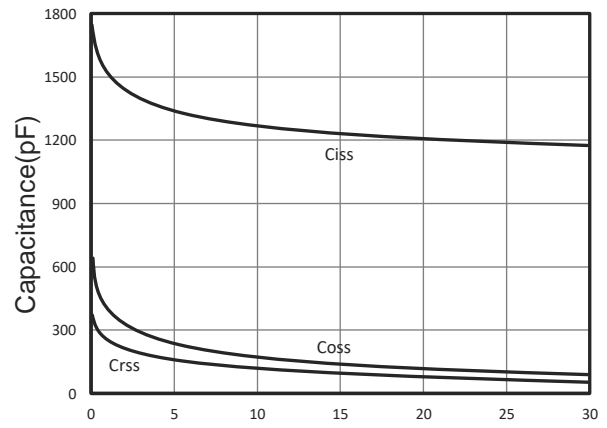

V_{DS}-Drain Source Voltage (V)
Capacitance

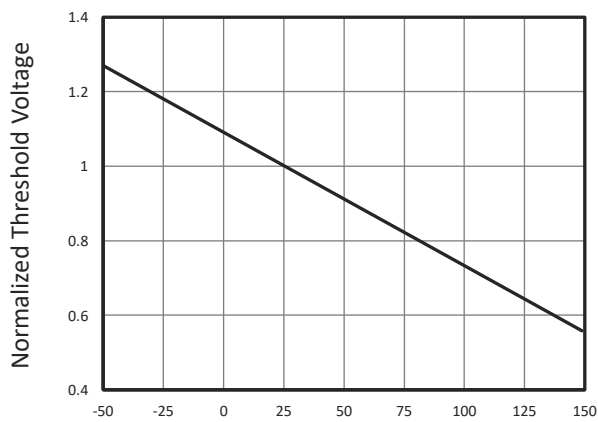

T_J-Junction Temperature (°C)
Gate Threshold Voltage

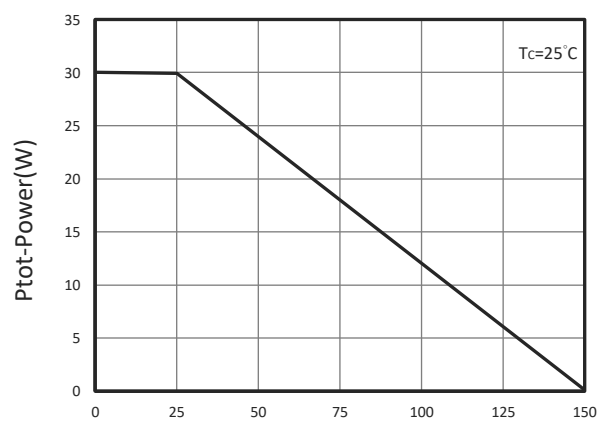

T_C-Case Temperature (°C)
Power Dissipation

TYPICAL CHARACTERISTICS

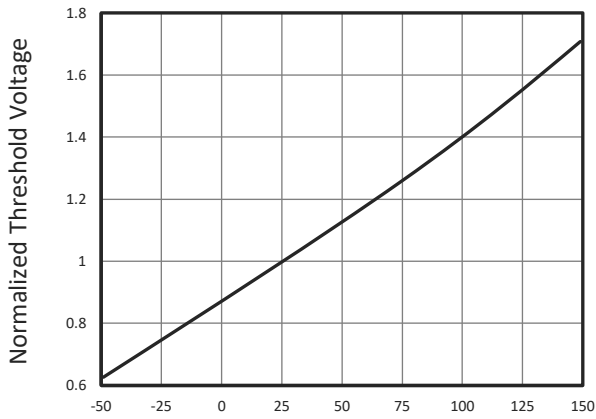

T_J-Junction Temperature(°C)
Gate Threshold Voltage

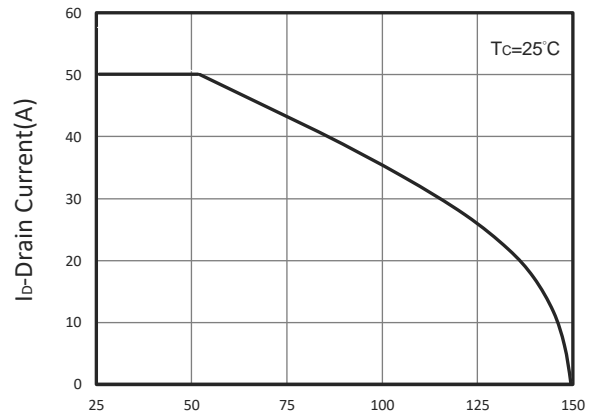

T_C-Case Temperature(°C)
Drain Current vs T_C

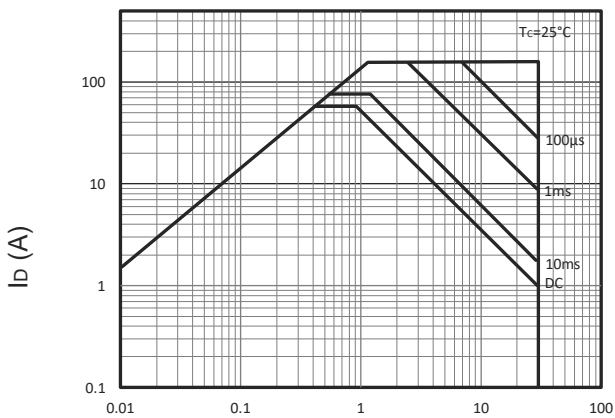

V_{DS} Voltage (V)
Maximum Safe Operation Area

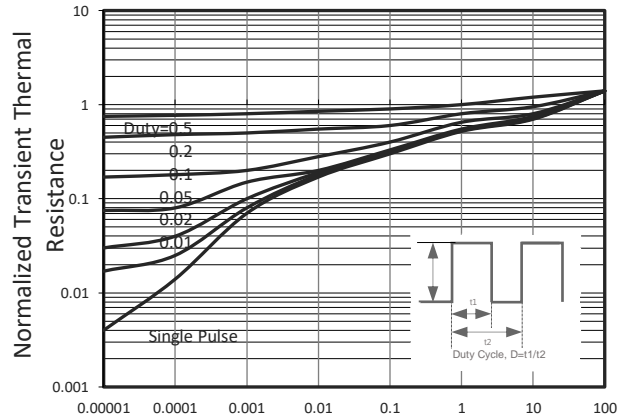

Square Wave Pulse Duration(Sec)
Thermal Transient Impedance

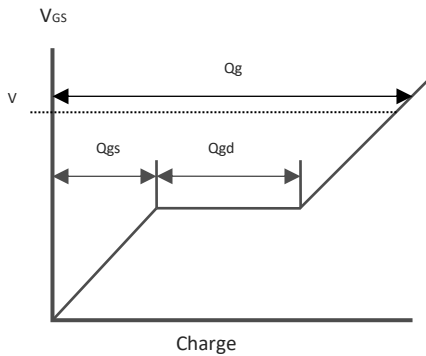

Gate Chrg Waveform

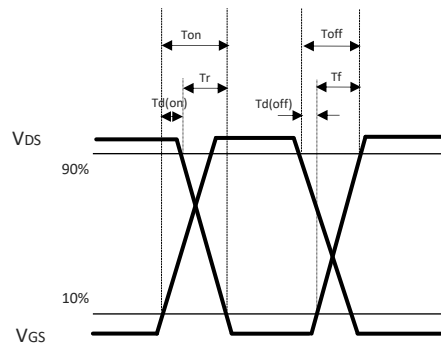

Switching Time Waveform

DFN3.3X3.3A-8 PACKAGE DIMENSIONS

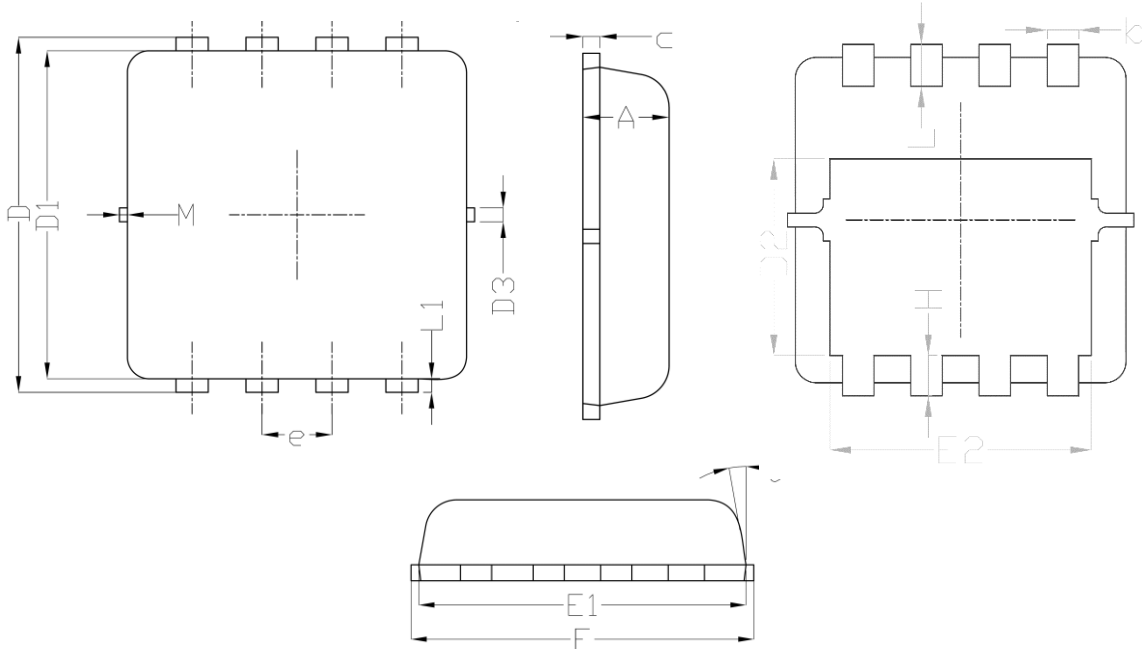

Symbol	Dimensions In Millimeters		Dimensions In Inches	
	Min.	Max.	Min.	Max.
A	0.700	0.800	0.028	0.031
b	0.250	0.350	0.010	0.014
c	0.100	0.250	0.004	0.010
D	3.250	3.450	0.128	0.136
D1	3.000	3.200	0.118	0.126
D2	1.780	1.980	0.070	0.078
D3	-	0.130	-	0.005
E	3.200	3.400	0.126	0.134
E1	3.000	3.200	0.118	0.126
E2	2.390	2.590	0.094	0.102
e	0.65BSC.		0.026BSC.	
H	0.300	0.500	0.012	0.020
L	0.300	0.500	0.012	0.020
L1	-	0.130	-	0.005
M	-	0.150	-	0.006
θ	0°	12°	0°	12°

Recommended Land Pattern

