

Single N-Channel MOSFET

DESCRIPTION

SMC4456NA is the N-Channel enhancement mode power field effect transistors are using trench DMOS technology. This advanced technology has been especially tailored to minimize on-state resistance, provide superior fast switching performance and withstand high energy pulse in the avalanche and commutation mode.

PART NUMBER INFORMATION

SMC 4456 NA - TR G
 a b c d e

- a : Company name.
- b : Product Serial number.
- c : Package code NA:DFN3.3X3.3A-8
- d : Handling code TR:Tape&Reel
- e : Green produce code G:RoHS Compliant

FEATURES

$V_{DS}=40V, I_D=40A$

$R_{DS(ON)}=7m\Omega(Typ.)@V_{GS}=10V$

$R_{DS(ON)}=10m\Omega(Typ.)@V_{GS}=4.5V$

◆100% EAS Guaranteed

APPLICATIONS

- ◆Load Switch
- ◆Power Management
- ◆DC/DC Converter



ABSOLUTE MAXIMUM RATINGS ($T_A = 25^\circ C$ Unless otherwise noted)

Symbol	Parameter	Rating	Units
V_{DSS}	Drain-Source Voltage	40	V
V_{GSS}	Gate-Source Voltage	± 20	V
I_D	Continuous Drain Current [*]	$T_C=25^\circ C$	40
		$T_C=100^\circ C$	27.4
I_{DM}	Pulsed Drain Current ^B	120	A
I_D	Continuous Drain Current	$T_A=25^\circ C$	15.7
		$T_A=70^\circ C$	12.6
P_D	Power Dissipation ^A	$T_A=25^\circ C$	3.6
		$T_A=70^\circ C$	2.3
I_{AS}	Avalanche Current ^A	25	A
EAS	Single Pulse Avalanche energy $L=0.1mH$ ^B	31	mJ
P_D	Power Dissipation ^C	$T_C=25^\circ C$	27.2
		$T_C=100^\circ C$	10.9
T_J	Operation Junction Temperature	-55/150	$^\circ C$
T_{STG}	Storage Temperature Range	-55/150	$^\circ C$

THERMAL RESISTANCE

Symbol	Parameter	Typ	Max	Units
$R_{\theta JA}$	Thermal Resistance Junction to Ambient ^A		35	$^\circ C/W$
	Thermal Resistance Junction to Ambient ^{AC}	$t \leq 10s$	65	
$R_{\theta JC}$	Thermal Resistance Junction to Case	Steady-State	4.6	

ELECTRICAL CHARACTERISTICS ($T_A = 25^\circ\text{C}$ Unless otherwise noted)

Symbol	Parameter	Condition	Min	Typ	Max	Unit
Static Parameters						
BV _{DSS}	Drain-Source Breakdown Voltage	V _{GS} =0V, I _D =250μA	40			V
V _{GS(th)}	Gate Threshold Voltage	V _{DS} =V _{GS} , I _D =250μA	1.2	1.8	2.5	V
I _{GSS}	Gate Leakage Current	V _{DS} =0V, V _{GS} =±20V			±100	nA
I _{DSS}	Zero Gate Voltage Drain Current	V _{DS} =40V, V _{GS} =0V, T _J =25°C			1	μA
		V _{DS} =32V, V _{GS} =0V, T _J =75°C			10	
R _{DS(ON)}	Drain-source On-Resistance ^D	V _{GS} =10V, I _D =15A		7	8.5	mΩ
		V _{GS} =4.5V, I _D =10A		10	12.5	
G _{fs}	Forward Transconductance	V _{DS} =10V, I _D =12A		20		S
Diode Characteristics						
V _{SD}	Diode Forward Voltage ^D	I _S =1A, V _{GS} =0V			1	V
I _S	Diode Continuous Forward Current [*]				40	A
t _{rr}	Reverse Recovery Time	I _S =15A, dI/dt=100A/μs		19		ns
Q _{rr}	Reverse Recovery Charge			10.5		nC
Dynamic and Switching Parameters^E						
Q _g	Total Gate Charge	V _{DS} =20V, V _{GS} =10V, I _D =12A		20.9	28.2	nC
Q _g	Total Gate Charge (4.5V)			10.2	13.8	
Q _{gs}	Gate-Source Charge			4.4	5.9	
Q _{gd}	Gate-Drain Charge			5.3	7.2	
C _{iss}	Input Capacitance	V _{DS} =20V, V _{GS} =0V, f=1MHz		1250		pF
C _{oss}	Output Capacitance			145		
C _{rss}	Reverse Transfer Capacitance			98		
R _g	Gate Resistance	V _{GS} =0V, V _{DS} =0V, F=1MHz		2.1		Ω
t _{d(on)}	Turn-On Time	V _{DD} =20V, V _{GS} =10V R _G =3.3Ω, I _D =1A		14	27	nS
t _r				9	17	
t _{d(off)}	Turn-Off Time			32	61	
t _f				9.2	17	

Note: Absolute maximum ratings are those values beyond which the device could be permanently damaged.

- A. Surface mounted on FR4 board using 1 in² pad size.
- B. Pulsed width limited by maximum junction temperature, T_{J(MAX)}=150°C.
- C. Using ≤ 10s junction-to-ambient thermal resistance is base on T_{J(MAX)}=150°C.
- D. Pulse test width ≤ 300μs and duty cycle ≤ 2%.
- E. Guaranteed by design, not subject to production testing.
- *. The maximum rating current is limited by bonding wire.

The products and product specifications contained herein are subject to change without notice to improve performance characteristics. Consult us, or our representatives before use, to confirm that the information in this datasheet is up to date. We assume no responsibility for any infringement of patents, patent rights, or other rights arising from the use of any information and circuitry in this datasheet.

TYPICAL CHARACTERISTICS

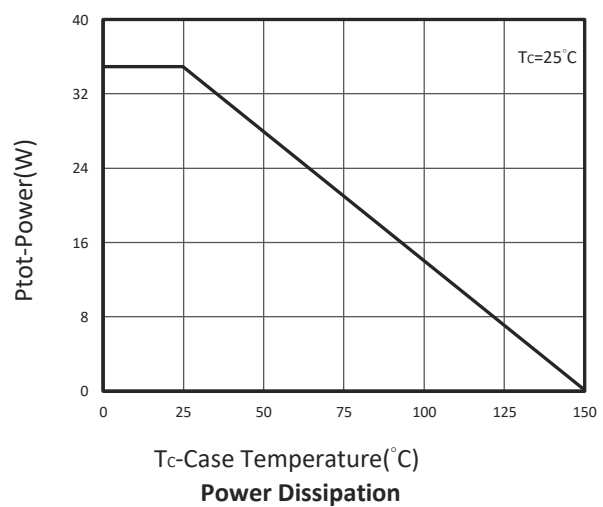
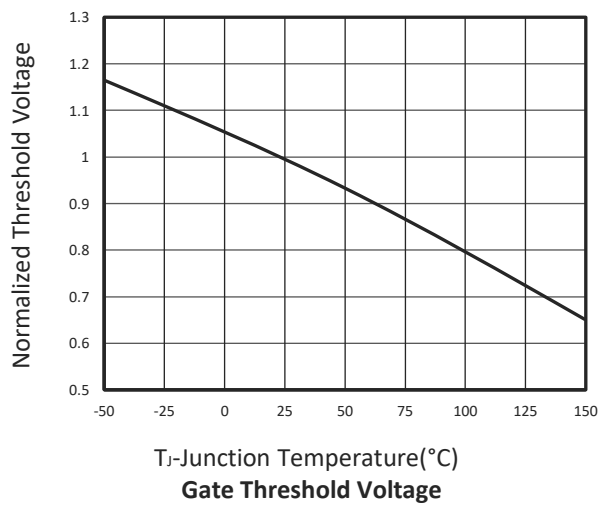
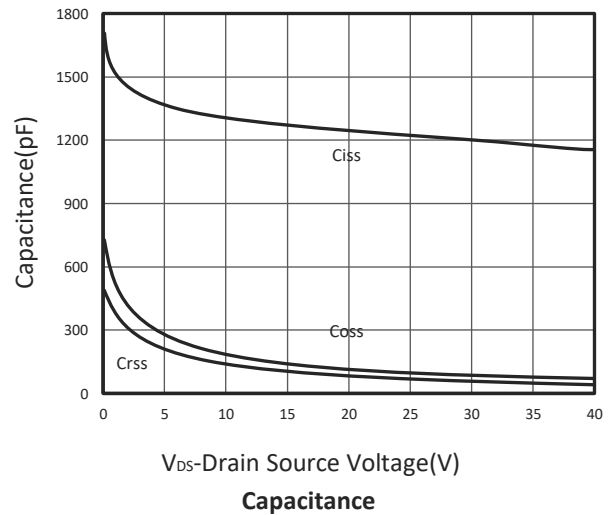
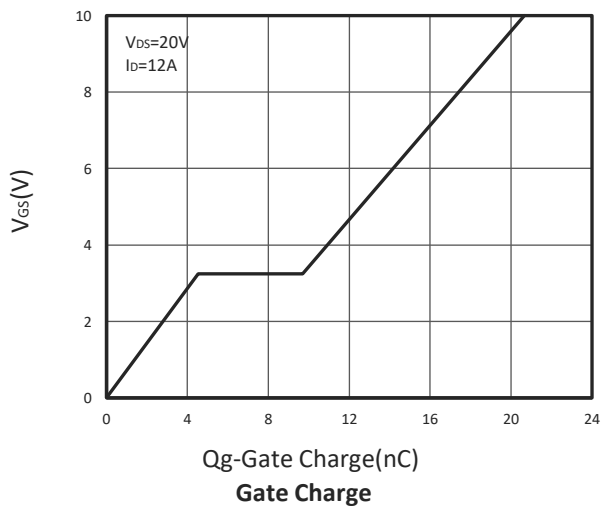
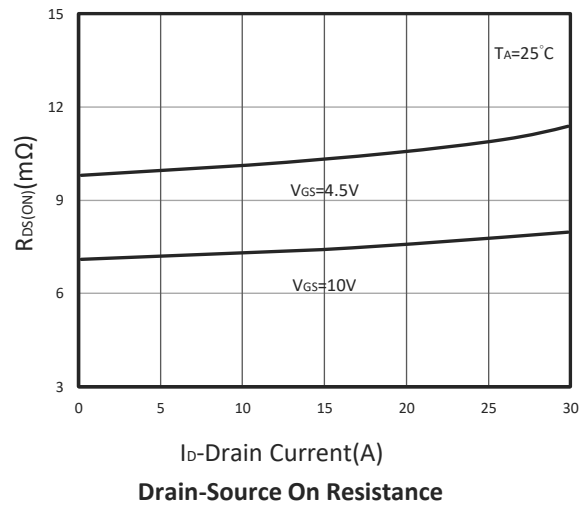
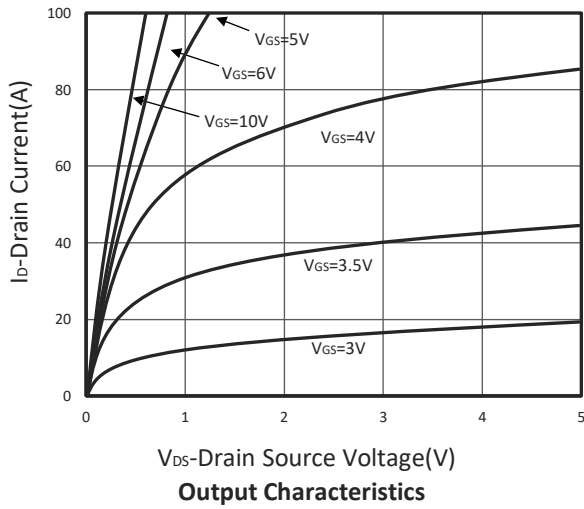

TYPICAL CHARACTERISTICS

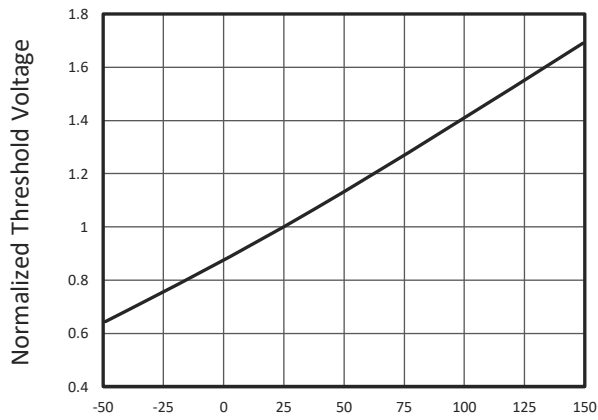

T_J-Junction Temperature(°C)
Gate Threshold Voltage

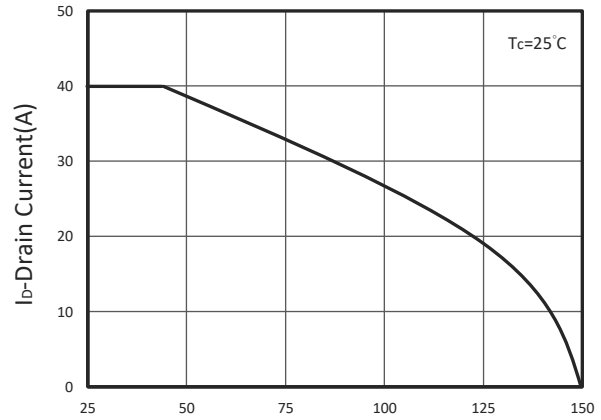

T_C-Case Temperature(°C)
Drain Current vs T_C

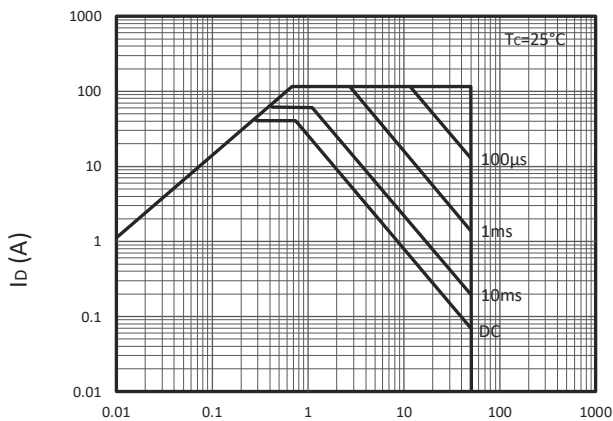

VD_S Voltage (V)
Maximum Safe Operation Area

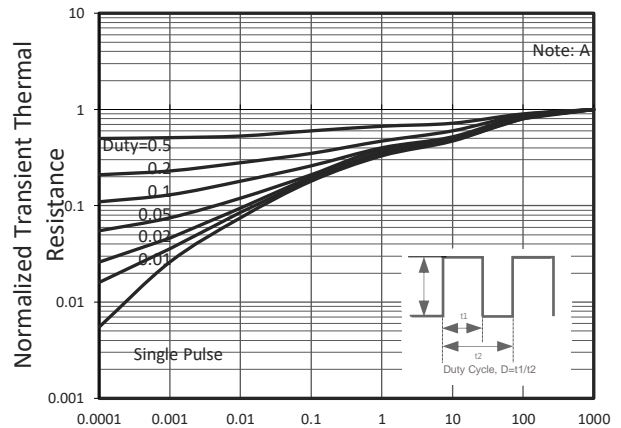

Square Wave Pulse Duration(Sec) (Note:A)
Thermal Transient Impedance

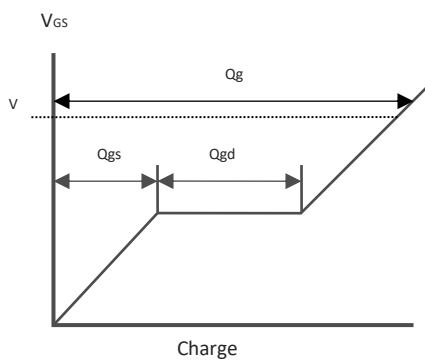

Gate Charge Waveform

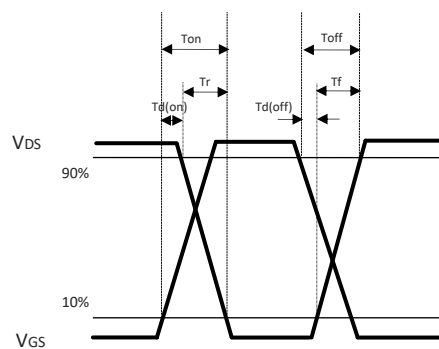

Switching Time Waveform

DFN3.3X3.3A-8 PACKAGE DIMENSIONS

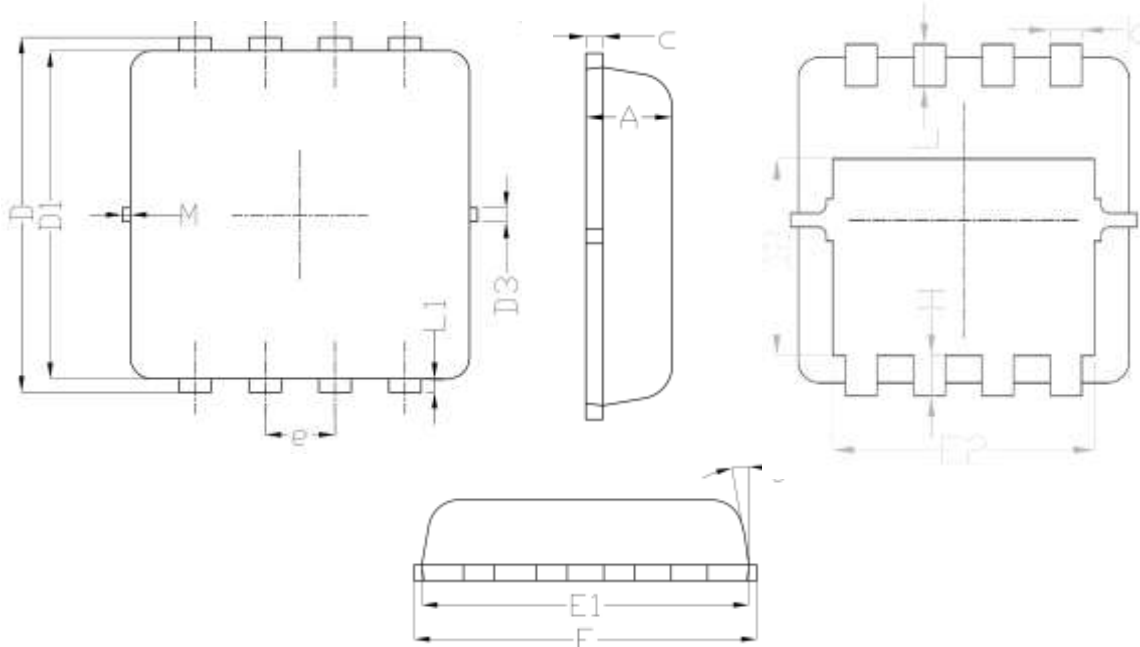

Symbol	Dimensions In Millimeters		Dimensions In Inches	
	Min.	Max.	Min.	Max.
A	0.700	0.800	0.028	0.031
b	0.250	0.350	0.010	0.014
c	0.100	0.250	0.004	0.010
D	3.250	3.450	0.128	0.136
D1	3.000	3.200	0.118	0.126
D2	1.780	1.980	0.070	0.078
D3	-	0.130	-	0.005
E	3.200	3.400	0.126	0.134
E1	3.000	3.200	0.118	0.126
E2	2.390	2.590	0.094	0.102
e	0.65BSC.		0.026BSC.	
H	0.300	0.500	0.012	0.020
L	0.300	0.500	0.012	0.020
L1	-	0.130	-	0.005
M	-	0.150	-	0.006
Θ	0°	12°	0°	12°

Recommended Land Pattern

